

PROJECT AT PREMISES NO.-260, BRAHMAPUR NATH PARA, WARD NO. 111 UNDER K.M.C, P.O. BRAHMAPUR, P.S. – BANSDRONI, DIST.- SOUTH 24 PARGANAS, KOLKATA – 700096

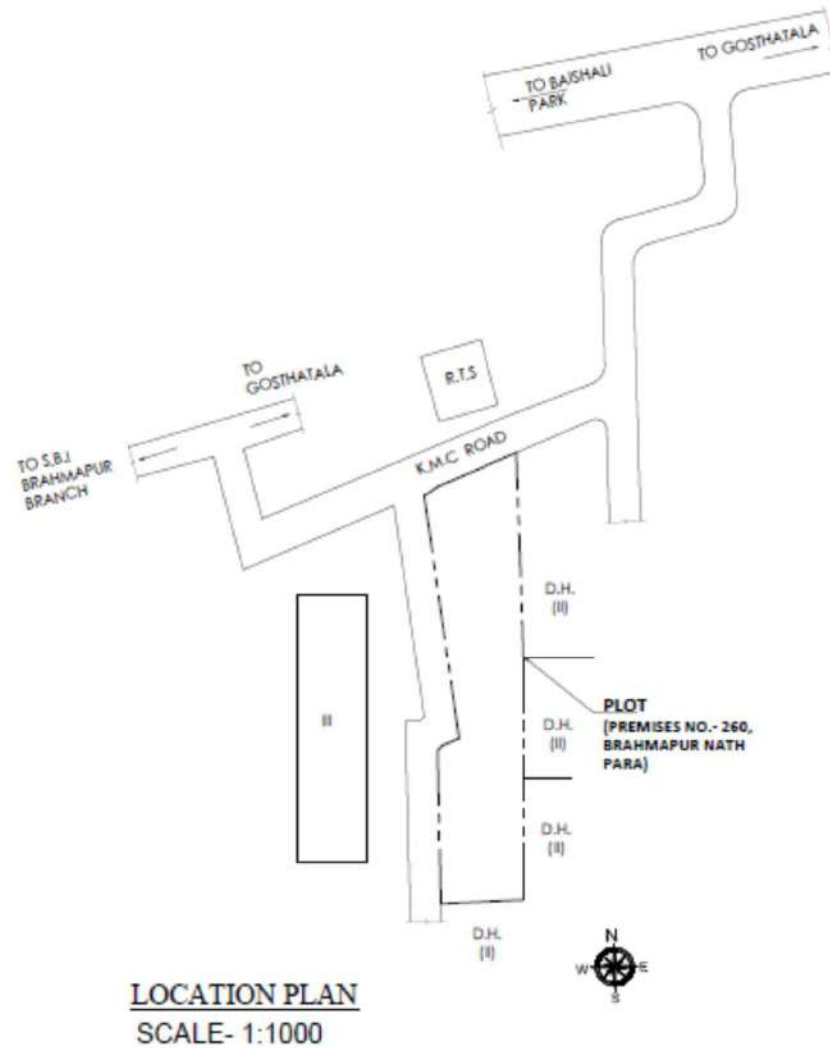
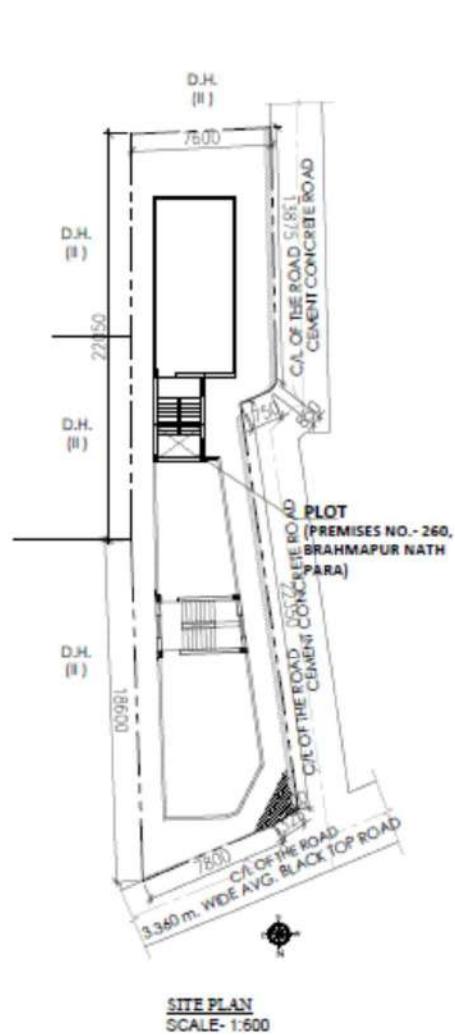

FOR MIJHERJEE ASSOCIATES

Aparna Mukherjee
Proprietor

LAT : 22.2747° N LONG: 88.225° E